

## Installation of Solar Panel (Optional)

- 1 Choose a location with maximum sunlight exposure year-round for the solar panel. Only a few hours of direct sunlight daily are needed to power your camera. Note that the solar panel's energy production can vary depending on weather, seasons, and location
- 2 Secure the base to your mounting location using the provided screws
- 3 Insert the locking screw cap into the universal joint, then screw the circular socket nut into the universal joint
- 4 Attach the universal joint to the back of the solar panel and tighten it securely with the nut
- 5 Screw the locking screw cap into the base, ensuring the universal joint is angled upward
- 6 To adjust the solar panel's left or right position, loosen the locking screw cap, rotate the sleeve rod, and tighten the cap when the panel is correctly positioned
- 7 Adjust the solar panel's angle up or down, to maximum of 90°

**Note:** After completing the installation, ensure all locking mechanisms are securely tightened.

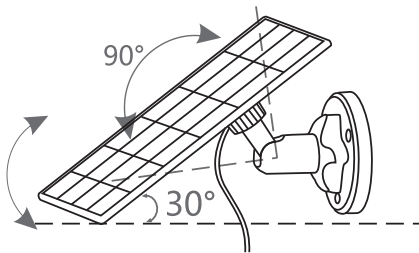

## Our Paw-some products for RVers



Warranty



Return Policy

[mywaggle.com/policies/terms-of-service](https://mywaggle.com/policies/terms-of-service)



In-App Chat Support



[support@mywaggle.com](mailto:support@mywaggle.com)

Scan the QR code  
or visit our store at  
[mywaggle.com](https://mywaggle.com)



waggle

4G Camera



User Manual



Camera



Mounting Bracket



Adapter



Screws



Power Cable



Solar Panel



Solar Panel Bracket

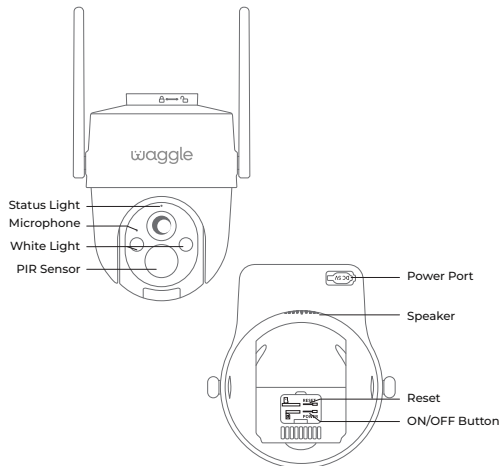

Includes SIM and SD Card

**Step 1: Download the "Waggle Pet App"**

App Store



Play Store

**Step 2: Add 4G Camera**

- Open the Waggle Pet App and select "Add Device"
- Choose "4G Camera" from the list of devices

**Step 3: Registration of Device**

- Scan the **QR code** located on the back of the **4G Camera** and enter the required details

**Step 4: Connecting the Device**

- Press and hold the Power Button to turn on the device
- Wait for a few minutes until the blue light starts flashing, then click "Next"
- Your 4G Camera will connect automatically in a few minutes
- The 4G Camera is now ready to stream live video

**Mounting the Camera**

- 1 Secure the expansion screws and the mounting screws
- 2 Place the camera into the bracket, aligning the black arrow on the camera with the "Unlock" symbol on the bracket
- 3 Turn the camera until it locks into place, with the black arrow aligned with the "Lock" symbol

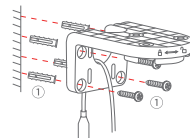
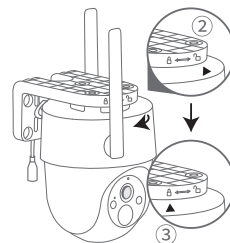
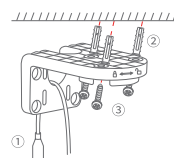
**Wall Mounting****Cell Mounting**

**Note:** Please refer to the **Installation video** by scanning the QR code

